

Samssoft 175

USER GUIDE

Patient lift



SAMSOFT 175 patient lift

CONTENTS

I - SPECIFICATIONS	3
1. Samssoft 175	3
2. Lifting assembly	3
II – INTENDED USE	3
III – ASSEMBLY PRINCIPLE	4
1. General terminology	4
2. Unpacking	4
3. Assembly	4
4. Folding	6
5. Separation of the basis besides of patient lift	6
IV - USING SAMSOFT 175	6
1. Commissioning:	6
2. Charging	6
3. Possible problems	6
4. Battery pack	6
V – TRANSFERRING A PATIENT	7
1. Base spacing:	7
2. Transferring the patient from a bed to an armchair	7
3. Transferring the patient from an armchair to a bed	7
4. Transferring a patient lying on the floor:	7
5. Moving	7
VI - DUPONT MEDICAL STRAP RANGE, AND STRAP MAINTENANCE	7
1. Controls	8
2. Cleaning	8
VII – SAMSOFT 175 MAINTENANCE	8
1. Cleaning	8
2. Disinfecting	8
3. Daily maintenance	8
4. Routine maintenance	8
5. Preventive maintenance	8
VIII – WARRANTY CONDITIONS AND RESPONSIBILITIES	9
IX – BEFORE CONTACTING DUPONT MEDICAL CUSTOMER SERVICE	9
XI - SPARE PART LIST	10

EXCLUSIVELY USE THE STRAPS PROVIDED BY
DUPONT MEDICAL

MAXIMUM PATIENT WEIGHT 175 Kg

PLEASE CAREFULLY READ THE INSTRUCTIONS
BEFORE USING THIS DEVICE

THIS DEVICE SHOULD BE USED BY QUALIFIED
AND FORMED PERSONAL.

NEVER USE A DEFECTIVE DEVICE.

YEARLY MAINTENANCE IS STRONGLY
RECOMMENDED.



Warnings

The renter must inform and show the user how to handle the patient lift stating the precautions and the risks related to inappropriate use. Pinching areas should be deeply explained. The renter should ensure the user perfectly understood the safety instructions.

When mounting and using the device, it is recommended to have the hands away from the pinching areas.

When the patient lift is exposed to heat source (sunrays through a window or radiator) for a long time, ensure there is no burn risk before using the patient lift.

The device should be used in a sufficiently clear place so that manoeuvres are not disturbed.

Since the straps are not fireproof, do not use the device near flames or to smoke.

Do not use or store the patient lift in a humid area or near water splashing (rain, shower, etc.).

In very particular use situations, the patient lift operation can be disturbed by radio and electromagnetic waves (proximity of radiotelephone antenna, etc.). In case of dysfunction, do not use the patient lift.

The patient lift operation can interfere with sensitive electronic devices. In this case, do not use the patient lift.

Because of the component weight and dimensions, there are hazards when dismantling and reassembling, so it is highly recommended to be assisted and to mind the pinching areas.

Symbols and explanations

Maximum user weight



Caution: hazard!



Carefully read the user manual



Device compliant to directive 93/42 EEC



This device is submitted to directive 2002/96/EC relative to waste electric and electronic equipment (WEEE) and it was marketed after 13 August 2005.



Serial number

USER AND MAINTENANCE GUIDE FOR SAMSOFT 175 PATIENT LIFT

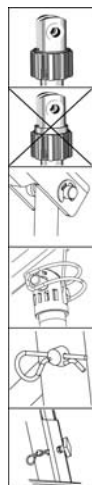

Verify that the red ring of emergency descent is in high position.

Check the sling loops are safely positioned inside hooks

Check the safety pin ring is locked in the right position

Check the safety pin is well engaged at the base of the mast

Check the knob is safely screwed

Label of identification:

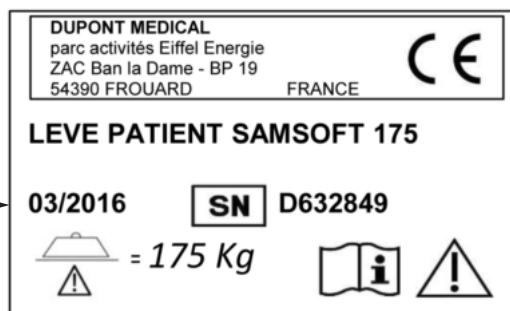

date of manufacture →

The label of identification is stuck on the crossbar.

I - Specifications

1. SAMSOFT 175

- Dimensions (folded) L x W x H 130 x 64 x 40 cm
- Dimensions (unfolded) L x W x H 133 x 63 x 134 cm
- Lifting capacity: 175 kg
- Inner feet spacing: 54 cm min. to 93 cm max.
- Turning diameter: 144 cm
- Base height: 9 cm
- Lifting time: 38 s. (empty)
- Patient lift weight: 38.4 kg
- Lifetime: 10,000 cycles at 175 kg
- Front wheels: dia. 7.5 x 6 cm without brake
- Rear wheels: dia. 7.5 x 6 cm with brake
- Structure: steel
- Coating: Epoxy RAL 7005 - 7004 - 3020
- Electric cylinder (lifting): 24 V continuous 8000N
- Mechanical cylinder rod disengagement (red ring)
- Battery power supply: 2 x 4.5 Ah, 12 V (Included into the battery pack)
- External battery charger
- Battery charge indicator: LED
- Buttons: emergency stop and emergency lowering
- Cycle number as for patient lift autonomy (lifting/lowering) with an average weight of 100 kg, with new charged batteries: 50 cycles.
- EC marking year: 2014
- Complies with NF EN ISO 10535 standard

Important: The patient lift should be used with straps (safety member) exclusively provided by Dupont Medical.

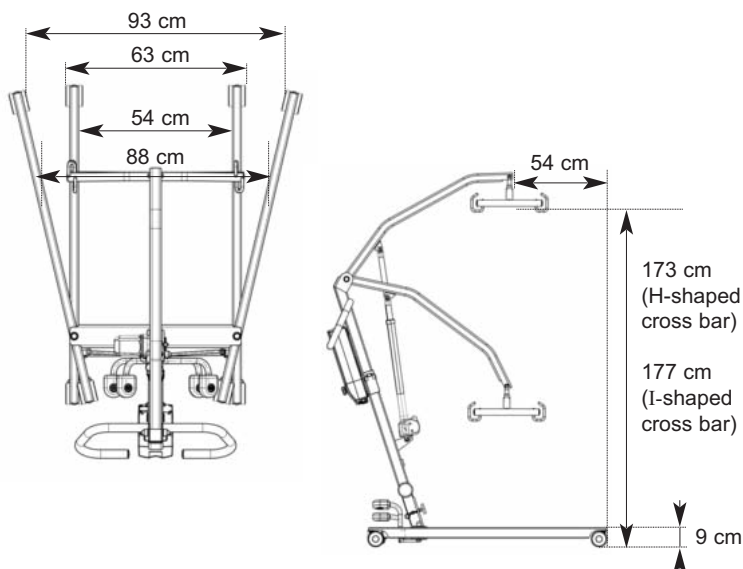

Dimensions +/- 1 cm

- Driven operating force:
- with one finger: < 5N
 - with one hand: < 105 N
 - with one foot: < 300 N

2. LIFTING ASSEMBLY

Autonomous box: (control box + battery pack)

Dimensions	L=368 W= 120 H=107.6 mm
Weight	4.8 Kg
Protection	Current limiter
Output voltage	24 V continuous
Output current	8.5 A maxi
Output number	1
Battery voltage	2 x 12-V batteries
Battery capacity	4.5 Ah
Autonomy	around 50 cycles
Charging time	8 h
Emergency stop push-button/Emergency lowering button (1) (2) (photo #2)	
Charged/discharged battery indicator	
Protection	IP 54

Actuator or cylinder:

Power supply	24 VCC
Max. center to center distance	895 mm
Max. stroke	300 mm
Max. thrust force	8,000 N
Lifting time when empty:	38 s
Lifting time when a patient is in:	54 s
No-load speed	26 mm/s
On-load speed	19 mm/s
Weight	3.5 Kg
Protection	IP X4
Mechanical decoupling/Safety nut	
Sound level:	≤60 dB

External battery charger:

Power supply	230 V AC 50-60 Hz
Output	24V continuous
Protection	IP20

(We reserve the right to change these specifications without notice).

USER AND MAINTENANCE GUIDE FOR SAMSOFT 175 PATIENT LIFT

II - Intended use:

- This transfer device is intended to transfer mobility-impaired patients; it can be used with a wheelchair, a shower seat, a bed, or a toilet seat.

 Not suitable for children under 12 year-old, for patients with mental disorders, and for patients whose morphology is incompatible with this kind of transfer device.

- SAMSOFT 175 should be used indoors exclusively on a flat and adherent floor; it should be handled by a competent caregiver trained for using this kind of devices

III - Assembly principle:

1) General terminology

- | | |
|-----------|-------------------------|
| 1 | MAST |
| 2 | BASE |
| 3 | CROSS-BAR |
| 4 | BOOM |
| 5 | LIFTING CYLINDER |
| 6 | REMOTE CONTROL |
| 7 | CONTROL BOX |
| 8 | BATTERY PACK |
| 9 | SIDE RAIL SPACING PEDAL |
| 10 | SIDE RAILS |

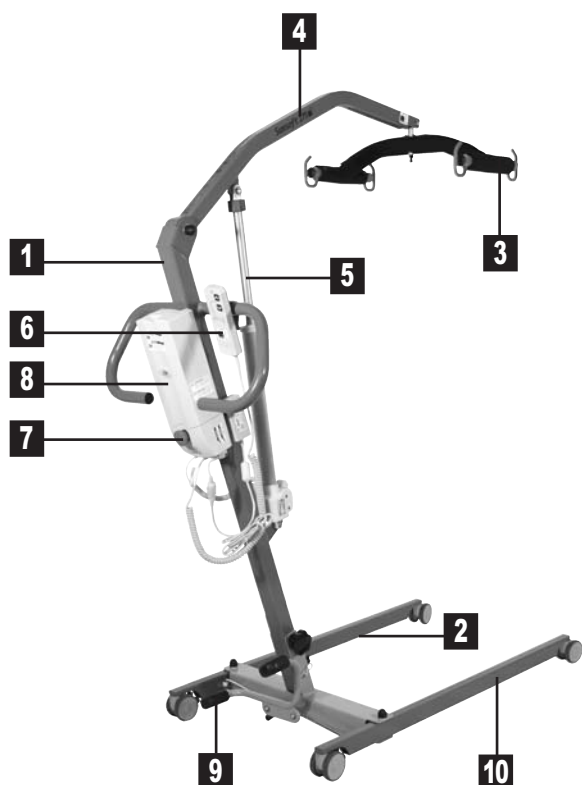

2) Unpacking

Check all the device elements have not been damaged during transport.

Check the accessories are present: the lifting assembly (box with battery pack, cylinder, remote control), battery charger, a user guide, and possibly a strap if it was ordered. NB: Our device is mounted and tested in our manufacturing site, but its packaging requires it to be folded.

3) Assembly

A - Provided parts:

1 - SAMSOFT 175 structure with lifting assembly: box (including battery pack) (photo # 2), cylinder and remote control, battery charger.

2 - SAMSOFT 175 user guide

3 - Possibly one strap if it was ordered

B - Structure installation:

1- Remove the structure from the box (possibly by cutting the box angles), lay the structure on a flat floor, and then lock the brakes and wheels.

2 - In the lower part of the mast, after removing the pin (6) (photo # 4), remove mast safety shaft (7) (photo #5).

3 - Straighten up the mast, and then position the mast safety shaft (7) into the second hole (8) and reposition the pin (6) (photo #°6).

Tighten backlash screw (9) (black wing screw) (photo #°6 bis).

4 - With the remote control, get the rod out of the cylinder in order to unfold the boom. The ball joint linking the cross-bar to the mast automatically disengages (photo #7).

5 - Check the box is correctly charged:

- Green: the batteries are totally charged
- Green/yellow: 3/4 charged batteries
- Yellow: 1/2 charged batteries.
- Yellow/red: the batteries are almost discharged, recharge them.
- Red: the batteries are discharged, they should be immediately charged otherwise their service life could be reduced.

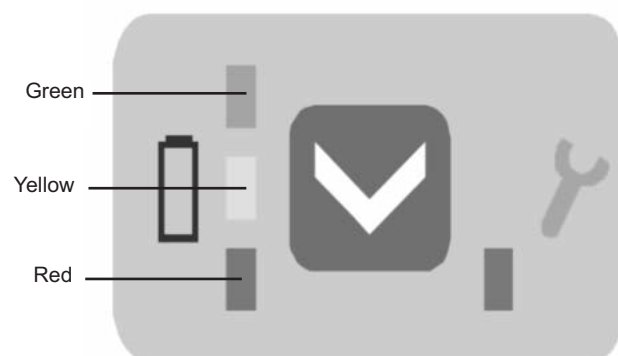

- If the red indicator is lit up (under the small key), the device requires special maintenance, please contact Dupont Medical Customer Service.

USER AND MAINTENANCE GUIDE FOR SAMSOFT 175 PATIENT LIFT

CAUTION: before using the device, make sure all the shafts, screws, and pins handled during the installation are perfectly engaged in their respective supports, and they are correctly locked.

SAMSOFT 175 IS OPERATIONAL ONLY IF THE STRAP CORRESPONDING TO THIS DEVICE IS USED, AND ONLY IF THE MAXIMUM 175-KG PERMISSIBLE LOAD IS RESPECTED.

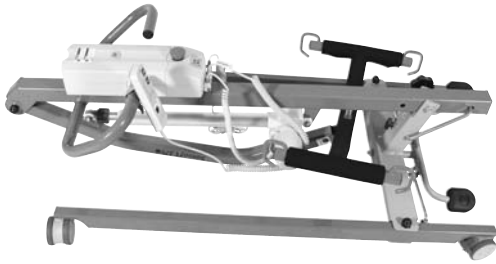

Photo #1 - SAMSOFT 175 when assembled and folded

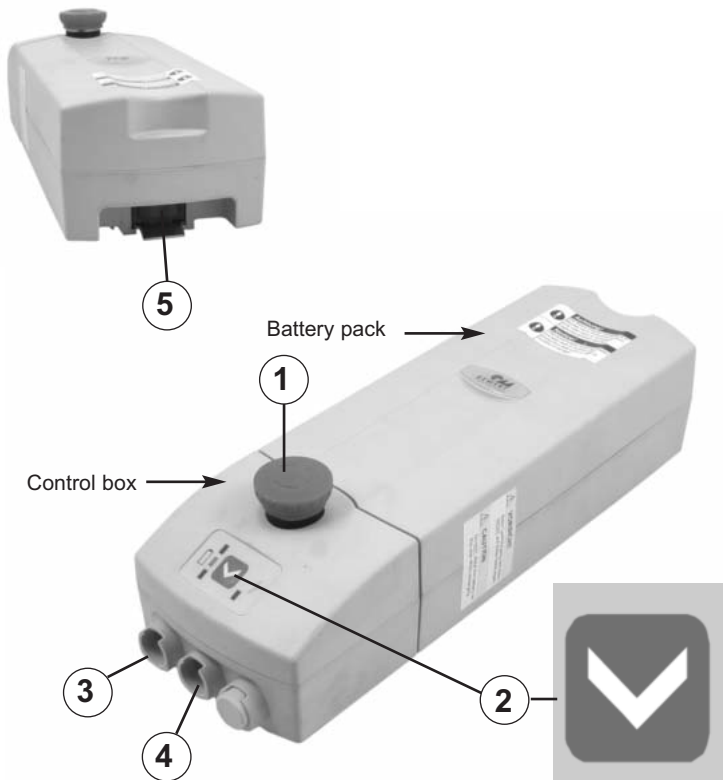

Photo #2
Supply box (including battery pack)

- 1 - Emergency stop push-button.
- 2 - Emergency lowering button
- 3 - Cylinder connection plug
- 4 - Remote control connection plug
- 5 - Battery pack unlocking knob

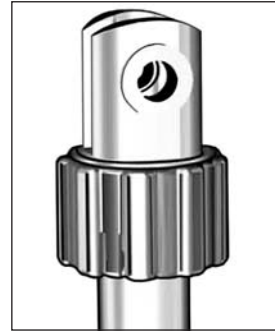

Photo #3

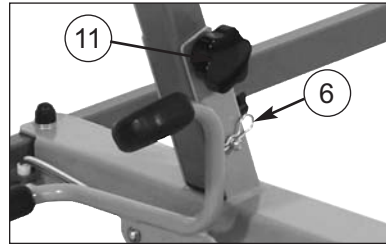

Photo #4
Safety pin

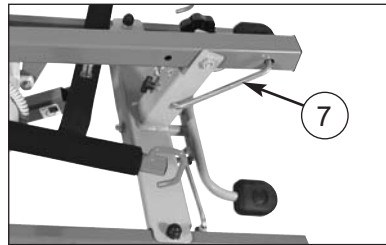

Photo #5
Mast safety shaft

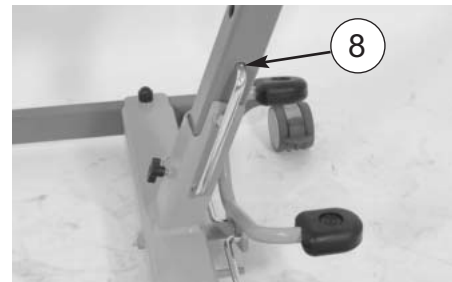

Photo #6
Position of the safety shaft when the mast is upright

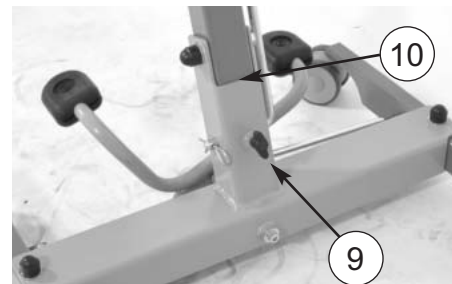

Photo n°6
Backlash screw



Photo n°7
Unfolding the boom

4) Folding

The device should be folded to be transported.
(Photo #°1).

- Press the remote control to refold the boom until the cross-bar ball joint is facing the mast clip (photo #7).
- Snap the ball joint into the mast.
- Remove the pin (6) and the mast safety shaft (7).
- Lower the assembly mast/boom/cross-bar onto the side rails.

CAUTION: pinching risk (10 photo #6)
- Reposition the mast safety shaft in its 1st position, and put its pin back.
- The device can be vertically transported or stored (photo #8).



Photo #°8
Samssoft 175 stored upright

5) Separation of the basis besides of patient lift

To facilitate the transport of Samssoft 175, it is possible to unsettle it in two parts by unscrewing completely the button (11) photo 4 and by removing the axis of safety (7) photo 5. Warning: Unscrew partially the backlash screw (9) photo 6 before separating the mast of the rolling basis. After reassembly, verify that all the elements of fixation and the pin of safety are firmly in place. Tighten strongly the button (11).

Rolling basis weight: 15,8 kg - Weight of the mast, arrow and crossbar : 22,6 kg

IV - Using SAMSOFT 175 :

WARNING
SAMSOFT 175 should be used indoors exclusively on a flat and adherent floor; it should be handled by a competent caregiver trained for using this kind of devices.

1. Commissioning:

- When all the connections are made:
- Use the patient lift with the remote control.
- Check the battery charge (see colour code in Chapt. III. 3 - B-5).
- The patient lift is ready to be used.

2 - Charging :

THE POWER UNIT SHOULD BE CHARGED EVERY NIGHT

IT SHOULD BE CHARGED IN A WELL-VENTILATED ROOM. CHECK THE POWER SUPPLY CORD CONDITION BEFORE PLUGGING IT.

-- To charge the battery, remove the battery charger from its support and plug it to the main power. When charging, the green indicator is blinking.

- When the indicator is steady green, charging is finished (see colour code in Chap. IV - B-5).
- The patient lift is ready to be used again.



Photo #°9

3 - Possible problems

- If the remote control cannot lower the patient, press the emergency-lowering button (2)(photo #°2).
- If the indicator is steady red when lowering or lifting the patient, charge the device.
- Check the connections if the remote control or the cylinder does not work.

IN CASE OF PROBLEM WHEN LIFTING OR LOWERING A PATIENT, PRESS THE EMERGENCY STOP BUTTON (1) (photo # 2), AND THEN RELOAD IT BY PULLING IT.

IN CASE OF POWER SUPPLY PROBLEM, IT IS POSSIBLE TO MANUALLY LOWER OR LIFT THE BOOM BY PRESSING AND TURNING THE RED RING LOCATED AT THE END OF THE CYLINDER ROD (photo #3).

DO NOT FORGET TO REPOSITION IT.

CAUTION: The cylinder should only be used discontinuously, that is to say: 2 minutes operating, and then 18 minutes resting. Do not exceed 2 minutes operating in continuous.

Any duty cycle exceeding the above cycle can damage the lifting assembly (cylinder/control box). This damage is excluded from the warranty.

4. Battery pack

The 2 batteries included in the box of the battery pack do not require any special maintenance. Though, they should be regularly charged to maintain their service life (at least every 3 months).

With a second battery pack (available on request), the device can work 24/24 hours.

V - TRANSFERRING A PATIENT :

Before positioning and transferring the patient, check that:

- The patient's weight is compatible with the maximum permissible load of the patient lift (175 kg maximum).
 - The batteries are charged and the patient lift is fully operational.
 - The floor is flat and stable.
 - The patient lift brakes are functional.
 - Check the strap is compatible with SAMSOFT 175 (DUPONT MEDICAL strap).
 - Check the strap fasteners and the patient support elements are in perfect condition.
 - In the maintenance book included in this manual, check regular maintenance is performed once a year at least.
 - If the patient is agitated, an accompanying person should secure the patient's movement.
- Once these checks performed, you can transfer the patient:

 **CAUTION: You should move the patient lift base apart to the maximum before lifting or moving the patient. Do not engage the wheel brakes. Do not keep on lifting or lowering the patient if the 4 wheels are not on the floor. The lifting task should be very progressive checking the patient is well positioned into the strap and there is no tipping risk due to excessive overhanging.**

1. Base spacing:

- Press the spacing pedal to open or close the SAMSOFT 175 base.

2. Transferring the patient from a bed to an armchair

- Position the patient on his/her side.
- Place the strap under the patient.
- Check the back part of the strap is correctly positioned (from shoulders to coccyx).
- Lay the patient on the back.
- Pass each leg support under each thigh.
- Position the patient lift at the patient's level.
- Hook each strap buckle inside the crossbar hooks.
- The patient can now be transferred from the bed to an armchair.

3. Transferring the patient from an armchair to a bed

- Lean the patient forward holding him/her.
- Slip the strap behind the patient's back up to the coccyx.
- Pass each leg support under each thigh.

- Position the patient lift at the patient's level.
- Hook each strap buckle inside the crossbar hooks.
- The patient can now be transferred from an armchair to a bed.

Particular points

- When positioning the strap, check there is no fold at the leg level in order not to hurt the patient.
- Do not engage the device brakes when lifting so that the device can correctly position with regard to the patient.

 **CAUTION! WHEN LIFTING OR LOWERING A PATIENT, NEVER ENGAGE THE WHEEL BRAKES SO THAT THE DEVICE CAN BE CORRECTLY POSITIONED, IN LINE WITH THE PATIENT. IN CASE OF POWER SUPPLY PROBLEM, IT IS POSSIBLE TO MANUALLY LOWER OR LIFT THE BOOM BY PRESSING AND TURNING THE RED RING LOCATED AT THE END OF THE CYLINDER ROD.**

4. Transferring a patient lying on the floor:

 **The patient's weight should not exceed 175 Kg** and the patient lift should be positioned so that the patient's head and trunk be located inside the side rails. Lift the patient very progressively ensuring he/she is well positioned on the straps.

5. Moving

Although this operation is strongly not recommended, it is possible to use the patient lift to move the hung patient on a very short distance (ex.: from the bed to the shower). Use the handles to move and guide the patient lift. Another person should secure the patient.

 Do not push nor pull the straps to move the patient lift. Do not move a patient if agitated.

VI - DUPONT MEDICAL strap range, and strap maintenance

4 transferring straps – max. upper load at 175 kg – of which 2 are available in 2 sizes

See specific documentation

<u>DUPONT reference</u>	<u>Designation</u>
SA6390100	Medium bath net
SA6390110	Large bath net
SA6390200	Medium comfort polyester
SA6390210	Large comfort polyester
SA6390500	One-size bath netted hammock
SA6390610	One-size toilet netted hammock

1. Controls

(before any use, and to be performed by a competent staff)

Before any use, check the condition of the straps. no undone sewing, the upholstery and the straps should not be fringed, no tear and no wear sign (transparent upholstery weft).

2. Cleaning

(each time it is necessary, and to be performed by a competent staff)

- The polyester straps can be washed at 40°C at the maximum. For other straps, see the strap instructions.
- The straps should be disinfected with detergent solutions (see below Chap. VII-2).

VII - SAMSOFT 175 maintenance :

Disconnect the power supply cord and remove the battery pack before any maintenance operation.

1) Cleaning :

(every month or when necessary, and to be performed by a competent staff)

- Clean the patient lift with a soft cloth dampened with soapy solution, then rinse, and carefully dry.
- Do not use aggressive detergent; do not soak.

2. Disinfecting

(when necessary, and to be performed by a competent staff)

- Disinfecting is performed with detergents and disinfecting solutions sprayed on the external chair areas. It is a foaming solution that does not require rinsing, but only drying.

Our internal services use ANIOS solutions.

3. Daily maintenance

- Charge the battery pack every night.

4) Routine maintenance :

(every month or when necessary, and to be performed by a competent staff)

The routine maintenance consists in checking the system functionality:

- With the bed positioned on a flat floor, check its 4 wheels are touching the floor.
- When the brakes are engaged, the patient lift should not be moved (flat and adhered floor).
- Operate the patient lift with nobody in, check the arm and the side rails move steadily with no noise.
- Control the handles located on the mast and check there is no play between the arm and the mast, and between the mast and the side rails.
- Check the plastic protective housings and casings are not broken or cracked, and all parts are present.
- Check the condition of the connecting cables: power

supply cord, remote control and cylinder; if a cable shows a slight burn, wear, or impact sign, or if the wires are visible, immediately stop using the patient lift, and have the cables replaced by the engineering department.

5) Preventive maintenance

(every year or when necessary, and to be performed by a competent staff)

- It is necessary to control the device every year.
- The battery pack should be changed about every 18 months depending on how it is used.
- The crossbar suspension axle should be imperatively checked yearly on each maintenance task.

The yearly maintenance should be performed by skilled technical staff experienced with electromechanical device maintenance.

The maintenance tasks do not require particular tools; adequate tools should be used according to the best industry practices.

Mechanical fastening, plays, and adjustments should be realised according to the best industry practices.

5.1 Mechanical control:

- Check the welding. Visual control.
- Check the alignments. Visual control.
- Control and lubrication after dismantling the mast and side rail pivots.
- Control and lubrication of the cylinder fastenings.
- Check the tightening of all the parts.
- Dismantling, cleaning, and lubrication of the front and rear casters.
- Dismantling, cleaning, and lubrication of the mast hinge.

Check the fastening, caster play, and brake performance. The mechanical parts that have cracks, wear signs or geometrical defects should be replaced with original components delivered by Dupont Medical.

5.2 Electrical inspection :

- Check the remote control.
- Check the charger.
- Check the remote control box and the cylinder.
- Check the lifting/lowering speed.
- Check the emergency stop and lowering.
- Condition of the electric cables (change the cables in case of doubt).

Replace the electric cables and/or the components to which they are connected if there are signs of wear, sheath cut, outlet damage or plastic and sheath darkening around the coupling area. Replace the electric cables and/or the components to which they are connected if there are signs of wear, sheath cut, outlet damage or plastic and sheath darkening around the coupling area.

 Never disassemble the protective housings of the cylinder, battery pack, remote control and control box, and battery charger.

5.3 Charging test:

- Charge the battery pack.
- Check the battery pack power and autonomy.
- Test the device when fully loaded (175 kg) and control the power cut threshold (230 kg +/- 10 kg).
- Tests.

5.4 Straps :

The straps should be checked at least once a year, or more regularly in case of intensive use, checking that: Sewing is not undone, the upholstery and strap weft is not visible, and there is no torn part.
Never use a defective strap.

 **The worn or malfunctioning parts should be replaced with original parts manufactured by DUPONT MEDICAL.**

Have some tries with a load before commissioning the patient lift again.

5.5. Service book:

Every maintenance operation or intervention should be recorded in the service book attached to these instructions.

5.6. Shipping, storage, and disposal:

- The patient lift should be returned or transported in its original packaging.
- Before storing the patient lift, clean it totally and check its performance. Store the patient lift in a dry place away from dust and humidity. The batteries should be totally charged every 3 months.
- When commissioning, after storing, charge the battery pack, and check its performance before using it again.
- Storage temperature: between 0 and + 50°C Humidity between 10 and 80%
- Service temperature: between +10 and + 40°C Humidity between 30 and 80%



- The disposal of defective parts, packaging and battery pack should be performed by approved waste treatment centres.
- The involved system should not be disposed of with household waste, but should be sent to an appropriate waste collection point or to a distributor.
- A financial contribution is given for collecting, dismantling, and recycling the system in question.
- By respecting these instructions, you respect the environment and participate in protecting the natural resources and the human health.

VIII - Warranty conditions and responsibilities :

SAMSOFT 175 is warranted for 5 years as far as the structure, the cylinder and the control box are concerned, and in case of normal use according to the instructions given in this guide. Negligence, handling errors and accidents are excluded from the warranty. The remote control is guaranteed for 3 months, and the battery pack is guaranteed for 6 months.

Any modification or addition of accessories without DUPONT MEDICAL's written consent will de facto exclude the product from the warranty and from DUPONT MEDICAL liability. In particular, using straps that are not marketed by DUPONT MEDICAL for this patient lift will not entail our liability.

The regular checks and inspections mentioned in the previous paragraph should be performed by a competent staff and recorded in the maintenance book. Out of the warranty period, our liability will not be entailed if you do not respect these controls and inspections.

Only spare parts and components provided by DUPONT MEDICAL can be used to repair the bed.

In case of unsolved technical problems, please contact the Customer Service:

Tel.: 03.83.49.54.51

Fax: 03.83.49.43.91

Email: sav@dupont-medical.com

A list of spare parts is provided in these instructions (see Chapter X).

IX - Before contacting DUPONT MEDICAL Customer Service:

Calling the Customer Service can often be avoided!

If the patient lift does not perfectly works, please perform the following checks first:

See Table on the following page

USER AND MAINTENANCE GUIDE FOR SAMSOFT 175 PATIENT LIFT

Problem	Possible cause	Solution	Problem	Possible cause	Solution												
- Nothing happens when one of the remote control keys is pressed.	- The remote control cord is not correctly plugged in its slot. - The remote control cable is cut. - The battery pack is not supplied. - The battery pack is discharged. - The cylinder connection plug is not correctly plugged. - The cylinder power cord is cut.	- Correctly plug the plug. - Replace the remote control. - Release the red push-button. - Charge the battery pack. - Correctly plug the plug. - Replace the cylinder.	- The red control box indicator lights up. - The red emergency lowering ring turns on the cylinder rod.	- The battery pack is discharged. - The cylinder rod is disengaged.	- Immediately charge the battery pack. - Push the ring upwards.												
- A cylinder produces abnormal noise.	- The duty cycle 2 min./18 min. was not respected. - The pinion or the nut supporting the lifting tube is damaged.	- Send the cylinder for an inspection to Dupont Medical Customer Service. - Send the cylinder for an inspection to Dupont Medical Customer Service.	X Spare part list:														
- The cylinder works, but very slowly.	- The battery pack is discharged. - The battery pack does not charge.	- Charge the battery pack. - Change the battery pack.	<table border="1"> <thead> <tr> <th>Designation</th> <th>Reference</th> </tr> </thead> <tbody> <tr> <td>Remote control</td> <td>SA6320900</td> </tr> <tr> <td>Battery pack</td> <td>SA6321000</td> </tr> <tr> <td>Lifting cylinder</td> <td>SR2850200</td> </tr> <tr> <td>Control box</td> <td>SA6321100</td> </tr> <tr> <td>Battery charger</td> <td>SA6320800</td> </tr> </tbody> </table>			Designation	Reference	Remote control	SA6320900	Battery pack	SA6321000	Lifting cylinder	SR2850200	Control box	SA6321100	Battery charger	SA6320800
Designation	Reference																
Remote control	SA6320900																
Battery pack	SA6321000																
Lifting cylinder	SR2850200																
Control box	SA6321100																
Battery charger	SA6320800																
- The batteries do not charge.	- The power supply cord is not correctly connected. - There is no voltage on the mains outlet.	- Check the mains outlet connection. - Check the wall socket is a mains socket.	For any other part that is not in the above table, please contact DUPONT MEDICAL Customer Service.														
- The red indicator under the small key is on.	- The device requires special maintenance.	- Contact Dupont Médical Client Service.															
- The yellow control box indicator lights up.	- The battery pack is half charged.	- Plan to charge the battery pack.															
- No control box indicator lights up.	- The battery pack is out of order.	- Change the battery pack.															

USER AND MAINTENANCE GUIDE FOR SAMSOFT 175 PATIENT LIFT

SERVICE

Serial number:

This document should be photocopied and delivered to the technician every time the patient lift is maintained. In case of incident, the liability can only be determined if all the sheets of this book are completed.

BOOK

.....

Facility:

SAMSOFT 175

.....

Date	Intervention nature Check, inspection, quotation, repairing, etc.	Intervention description	Technician's name and position

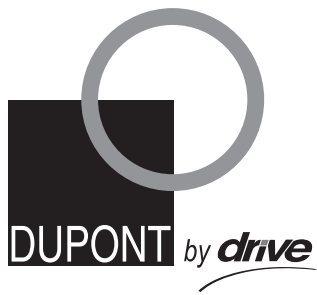

Samssoft 175



Ref. M54068000 - 09/2016 - Rév. 2

DUPONT MEDICAL

BP19 - Parc d'activités Eiffel Energie - Site de Ban la Dame
54390 FROUARD (France)

Tél. +33 (0)3 83 495 495 - Fax +33 (0)3 83 495 496
www.dupont-medical.com

SAMERY®

A DUPONT MEDICAL trademark